



PLANOS
DE LOS
JARDINES



Ayuntamiento de Madrid

M

B

11

MB

Dear

1896

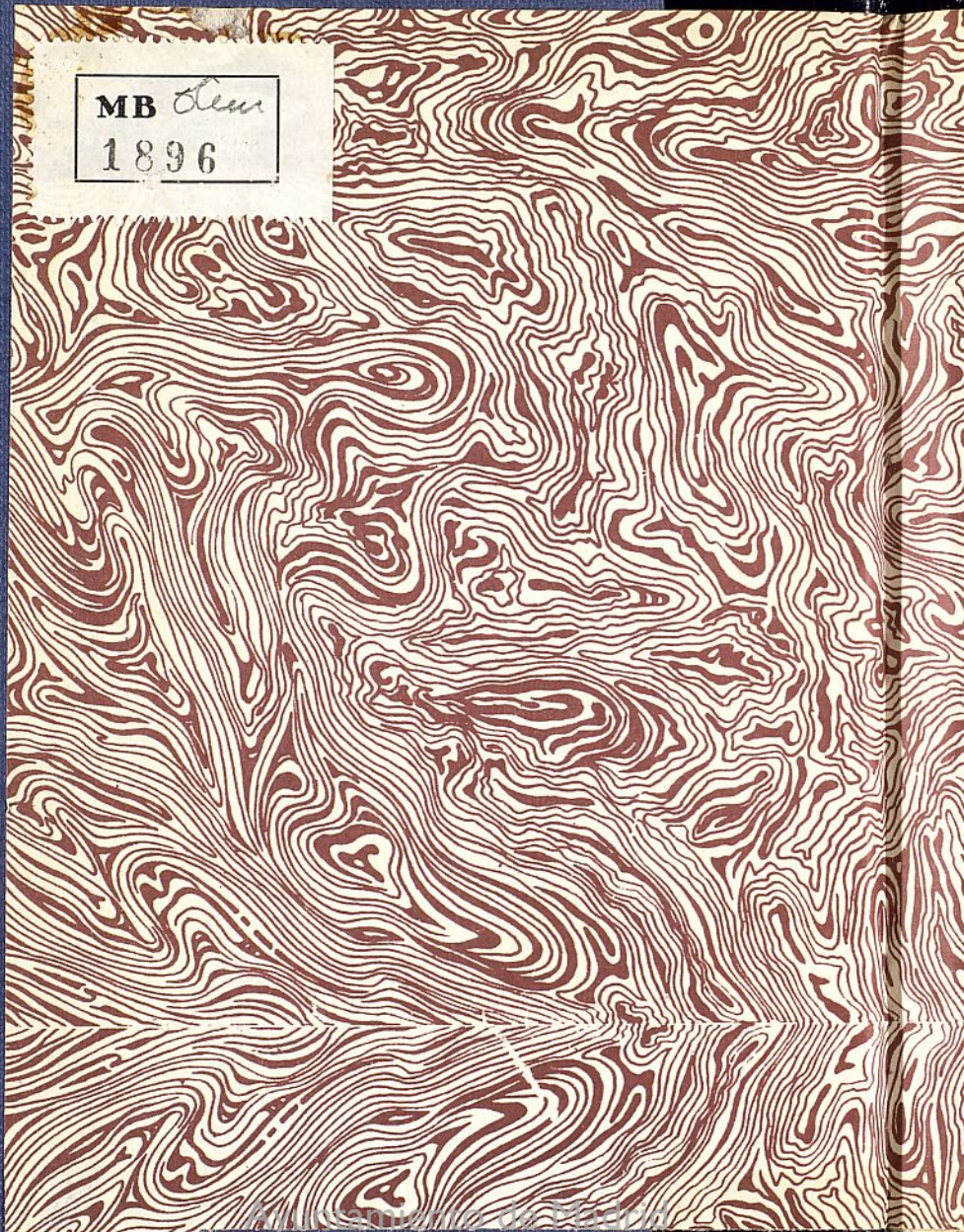



MB 1711



1354

1-46

PLANOS

DE LOS

Jardines

DE

Manuel...



S

Barbajan 1.896
olim

MB olim
1.896

olim
Barbajan 1.896

MB

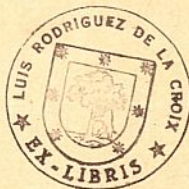

50525



Parcela de los Jardines.

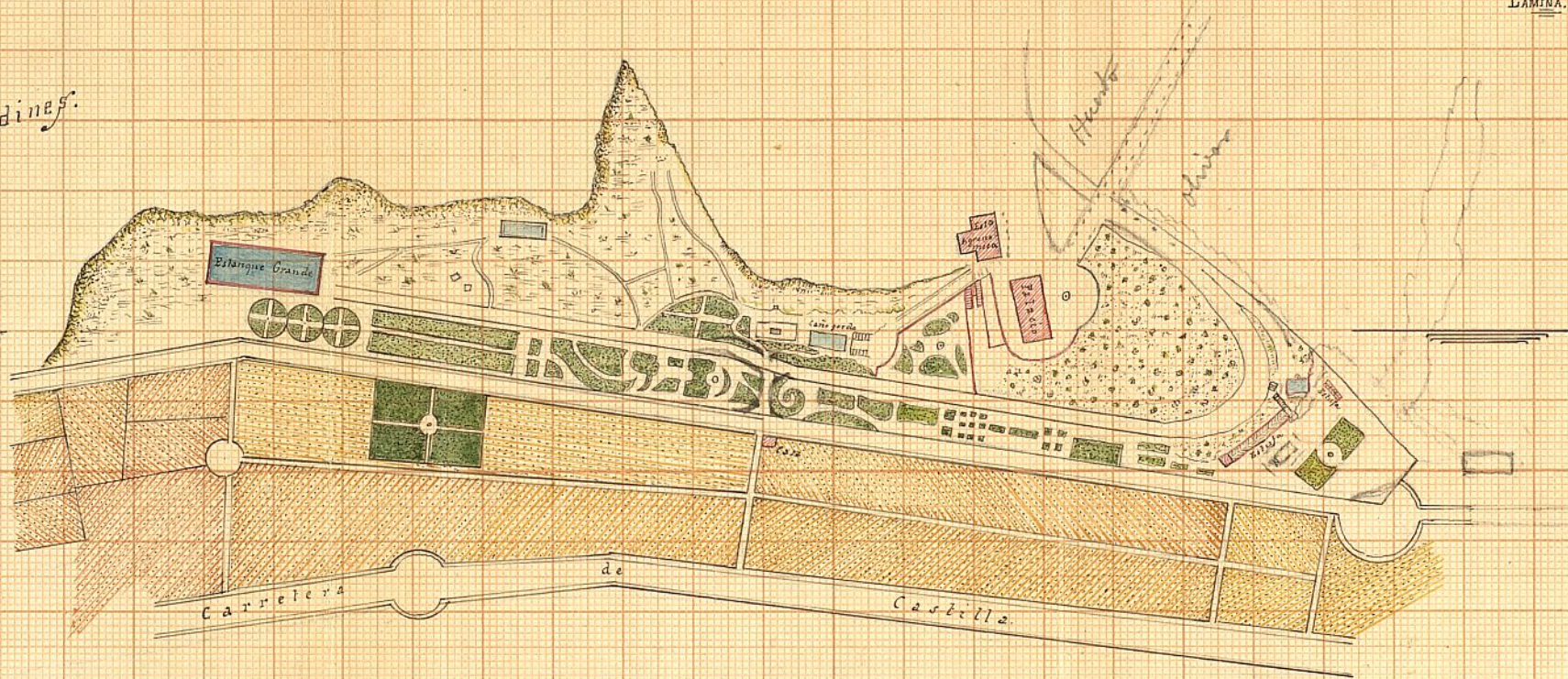

Escala de 1:4000 mtrs.

Superficie - 5. hectareas, 10 areas y 49 metros cuadrados

A. Paredes.

Ayuntamiento de Madrid

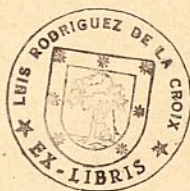

Viveros.

N. N.



Parcela de las Manzanas.

CALLE DE CARRETERAS.

Límite actual de la Manzana.

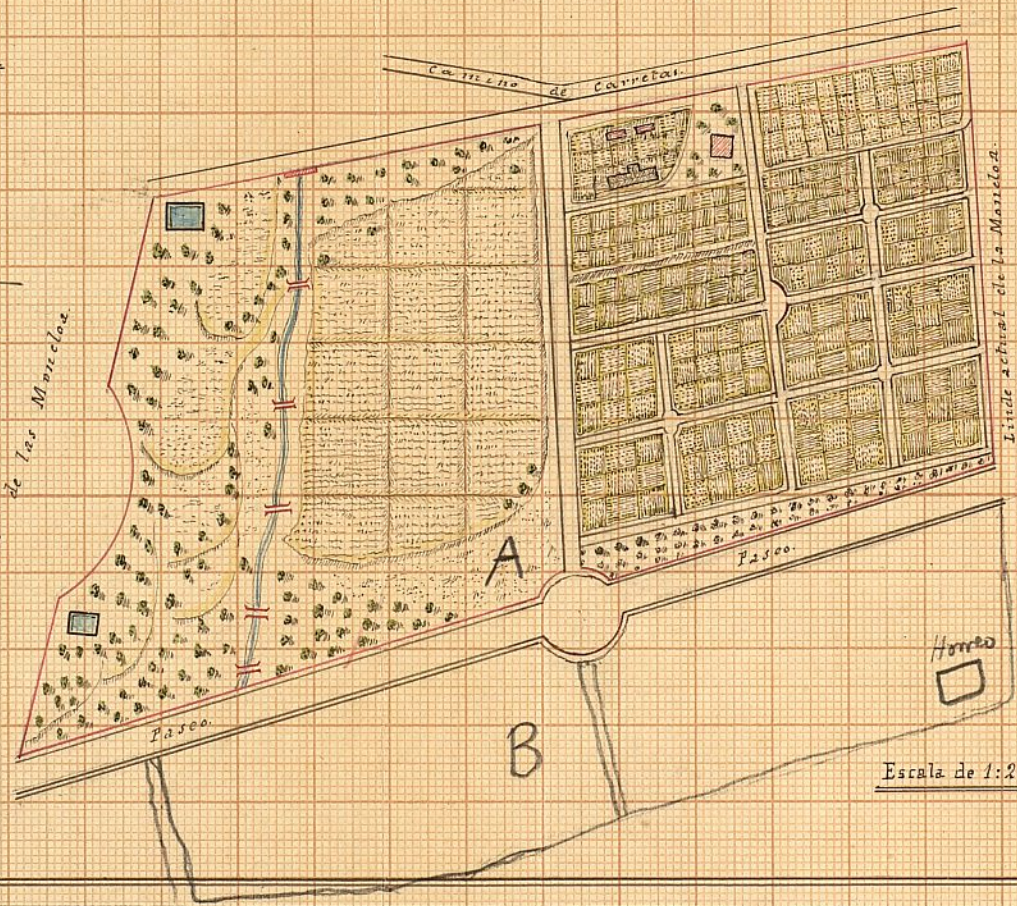

Escala de 1:2000.

A Tardeco.

A - Superficie = 2 hectareas, 82 areas y 48 metros cuadrados } 2. hect. y 85 areas y 48 mt.
B - id = 0 - - - - - 33 areas de Madrid

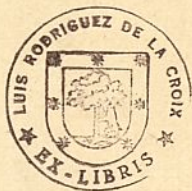

A. PARET

Jardin de las Estufas.

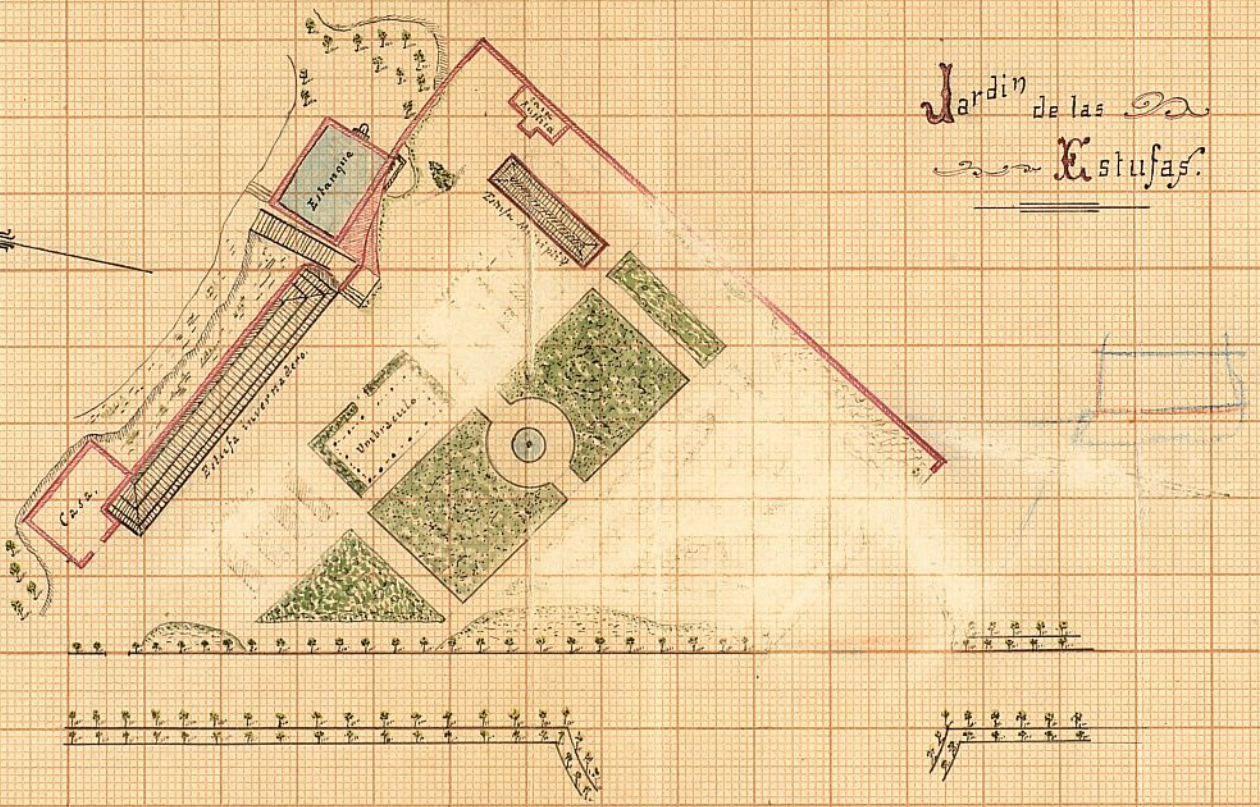

Escala de 1:1000.

A. PAREDES.

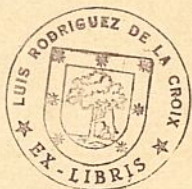

— Estufa de Multiplicacion. —

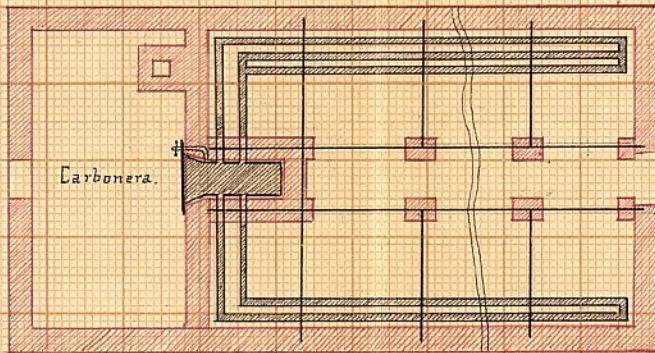
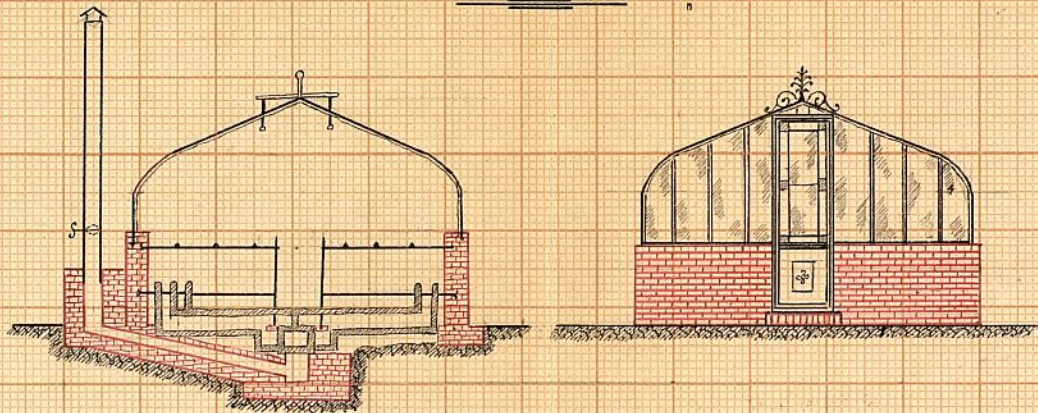

Escala de 1:100.

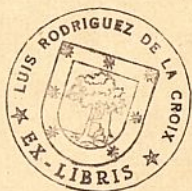

LAMINA 5^a

ИВЕРНАДЕРО.

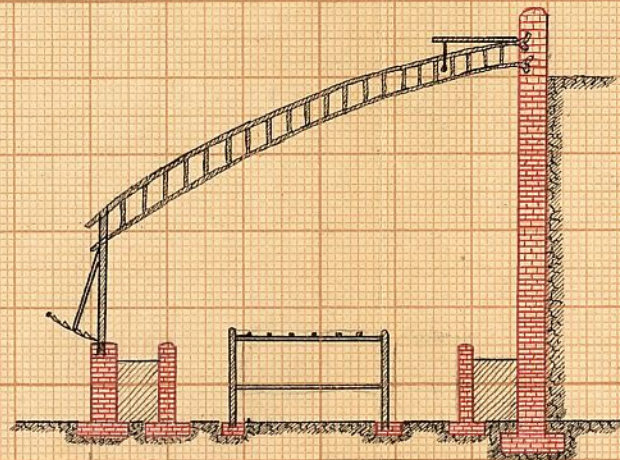

Escala de 1:100.

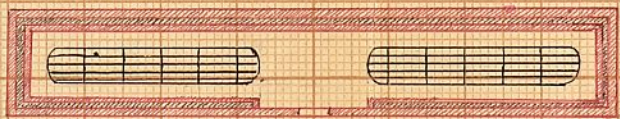

Escala de 0'0025 por 100.

A. Paredes.



Casa de los
Viveros.

LAMINA 6.

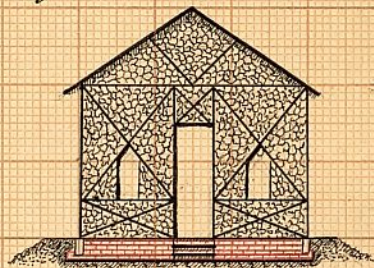

Frente

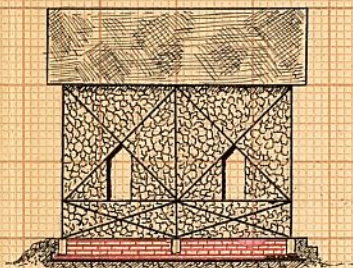

Costado.

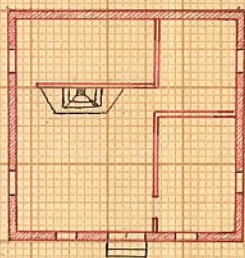

Planta.

Escala de 1:200.

A. Paredes.



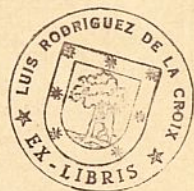

Jardin de la Princesa.

Lamina 7.

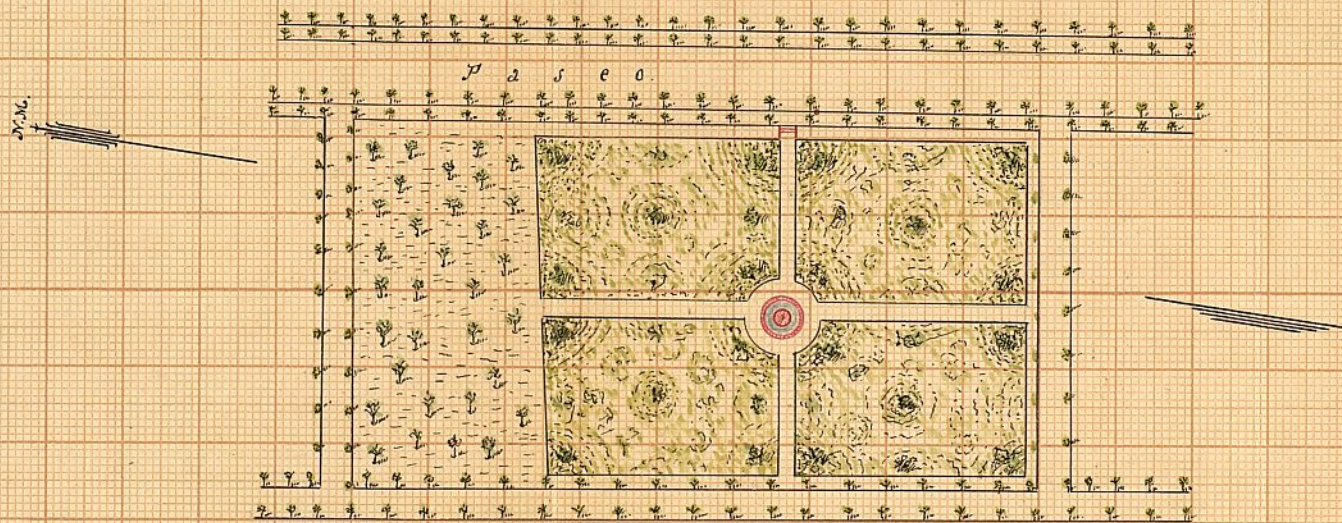

Escala de 1:1000.

A. Paredes.

No

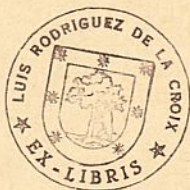

Jardin del "Laberinto,,

LAMINA. 8.

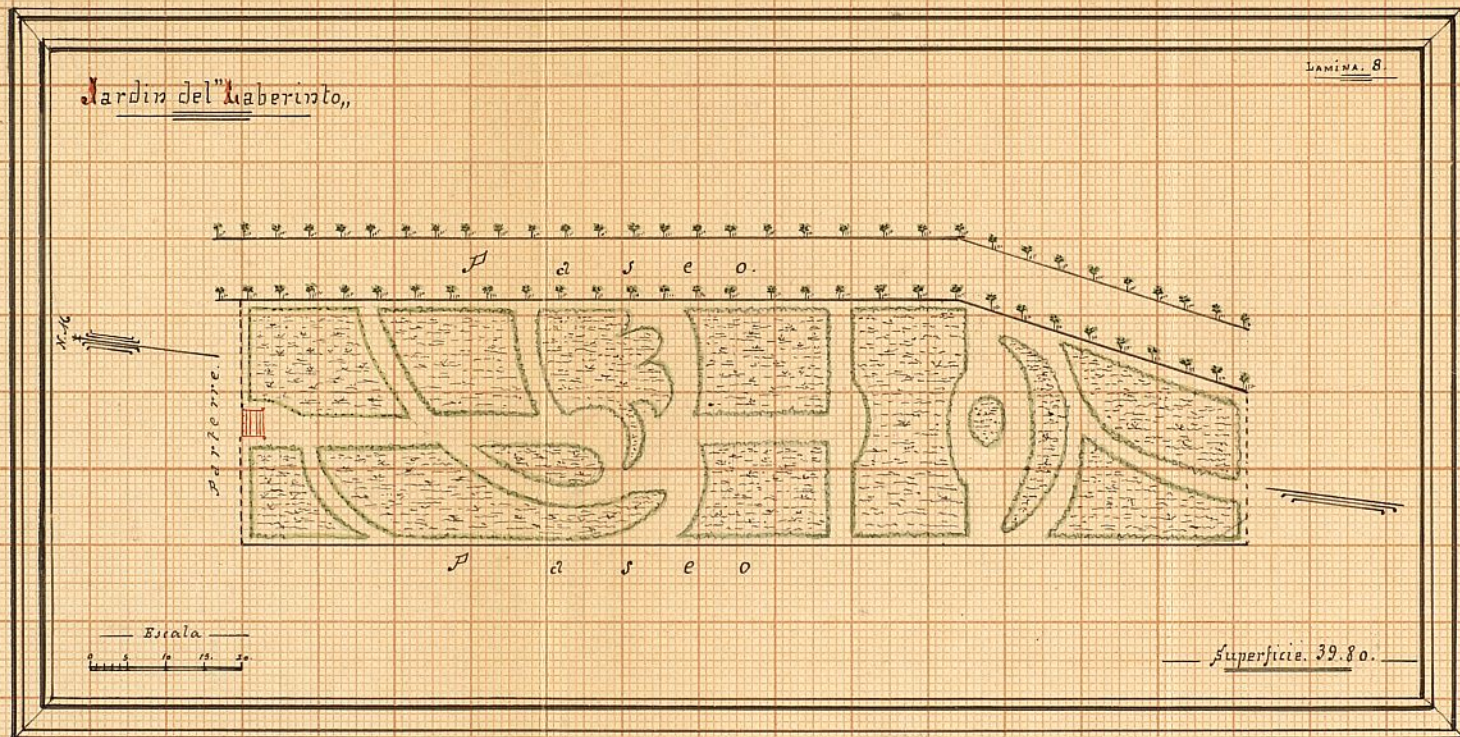

A. Paredes.

Ayuntamiento de Madrid

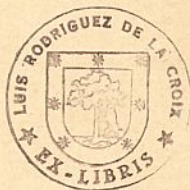

Jardin del "P" arterre..

LAMINA 9.

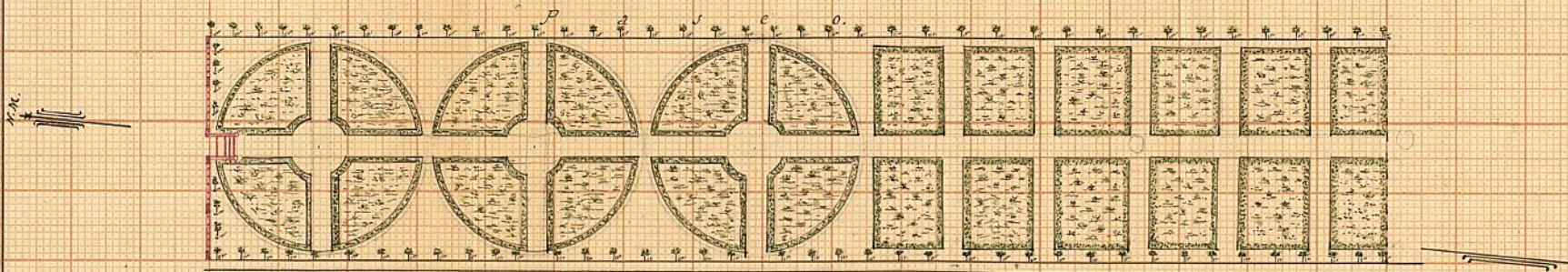

P a s e o.

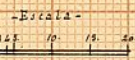

Superficie. 54.40.

A. Paredes.



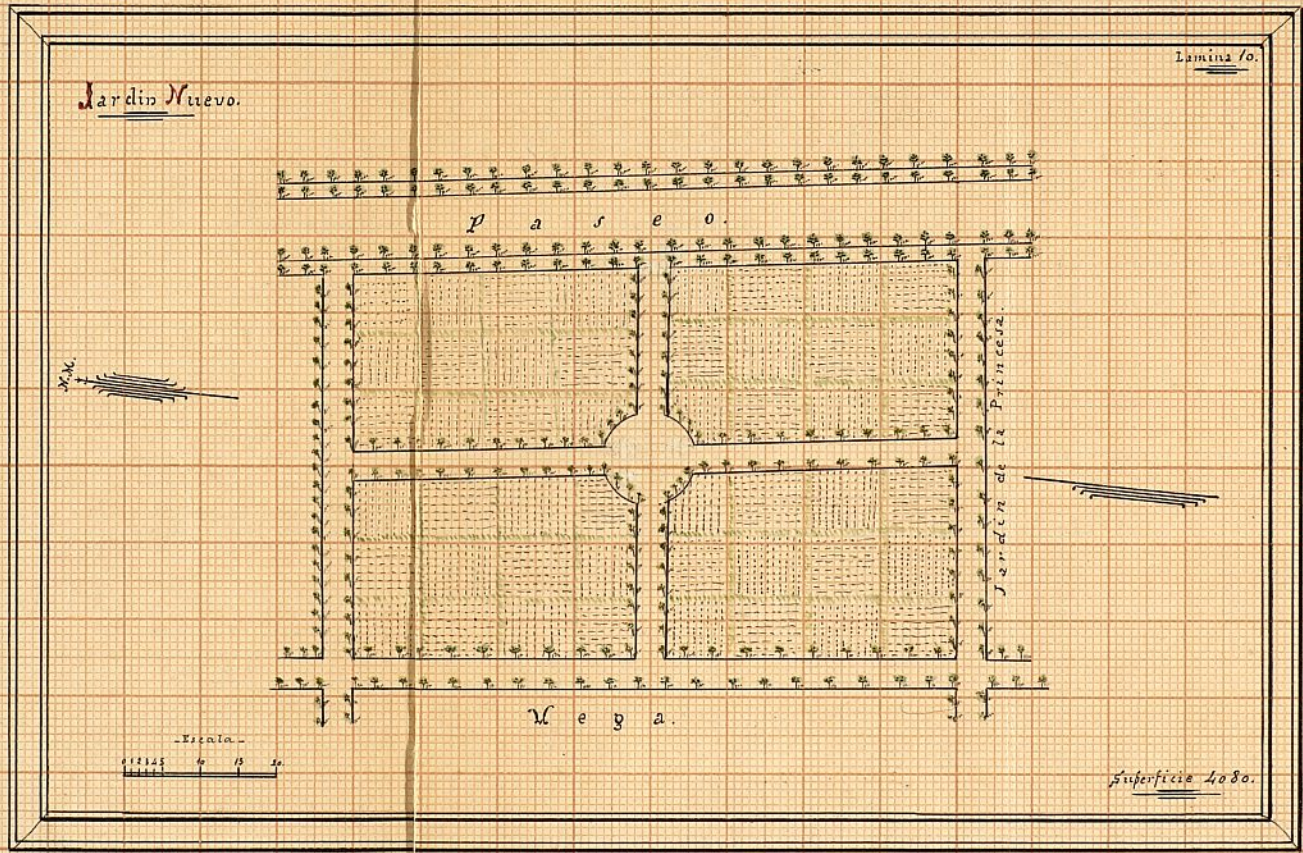

SUPERFICIES.

Lamina 1 ^a	Parcela de los jardines	5.10.49.
" 2 ^a	Viveros	2.52.45.
" 3 ^a	Jardin de las estufas.	1.22.00
" 4 ^a	Estufa de Multiplicacion	28
" 5 ^a	" Invernadero.	187.
" 6 ^a	Casa de los Viveros.	36 m ²
" 7 ^a	Jardin de la Princesa	22.26.

La Mananera (Madrid) 21 Febrero 1905.



APUNTES.

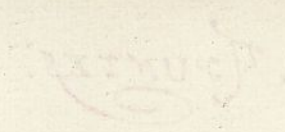

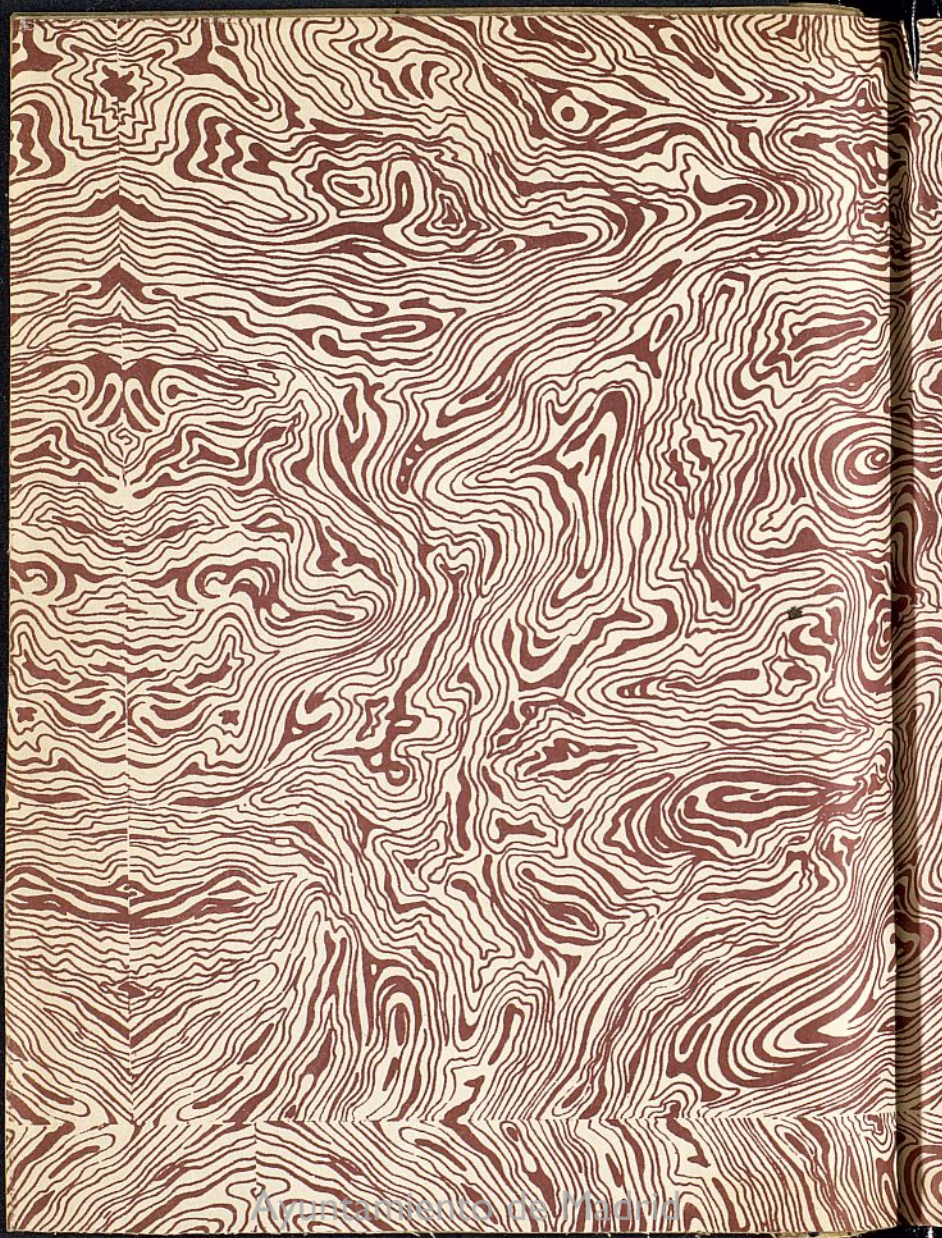

BIBLIOTECA HISTORICA MUNICIPAL



1200013711

Ayuntamiento de Madrid

B
M
17