

(1) Calcar parte
en curva de
la fachada
p^a Boutoues
inventando
el dibujo

Seja de cerramiento en el Pared Imperial

Ayuntamiento de Madrid

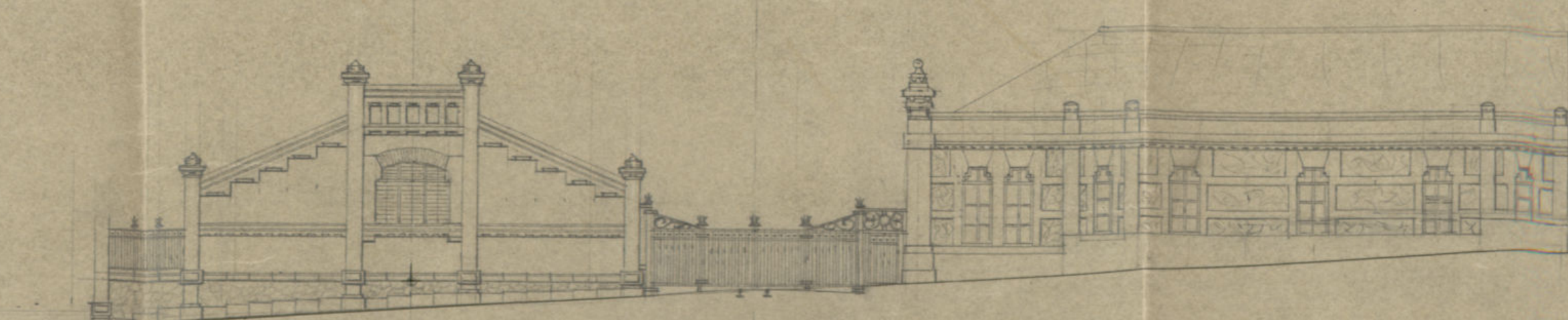
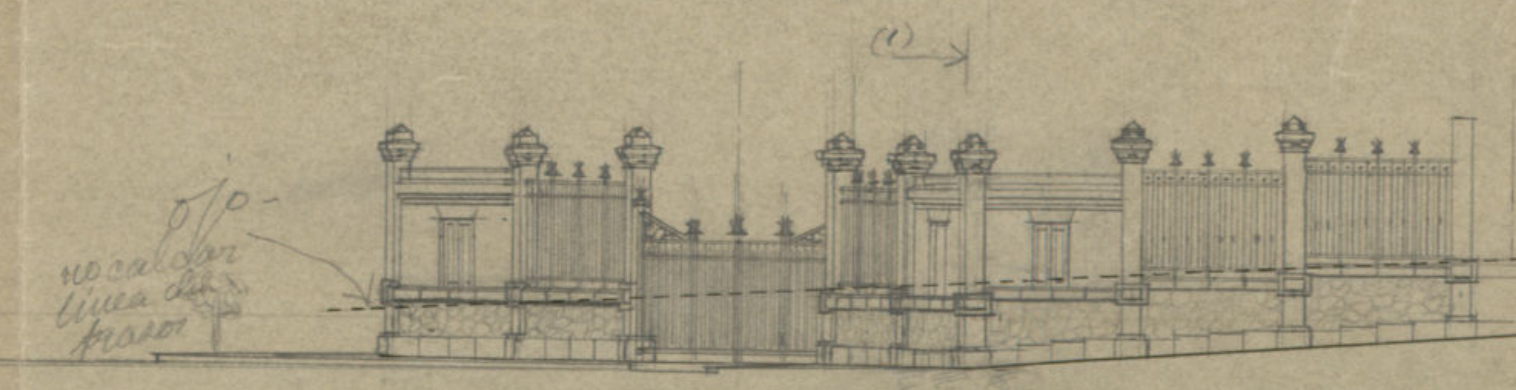

Ayuntamiento de Madrid

Academia de San Fernando

Perfil por el encintado del paseo de los Pontones

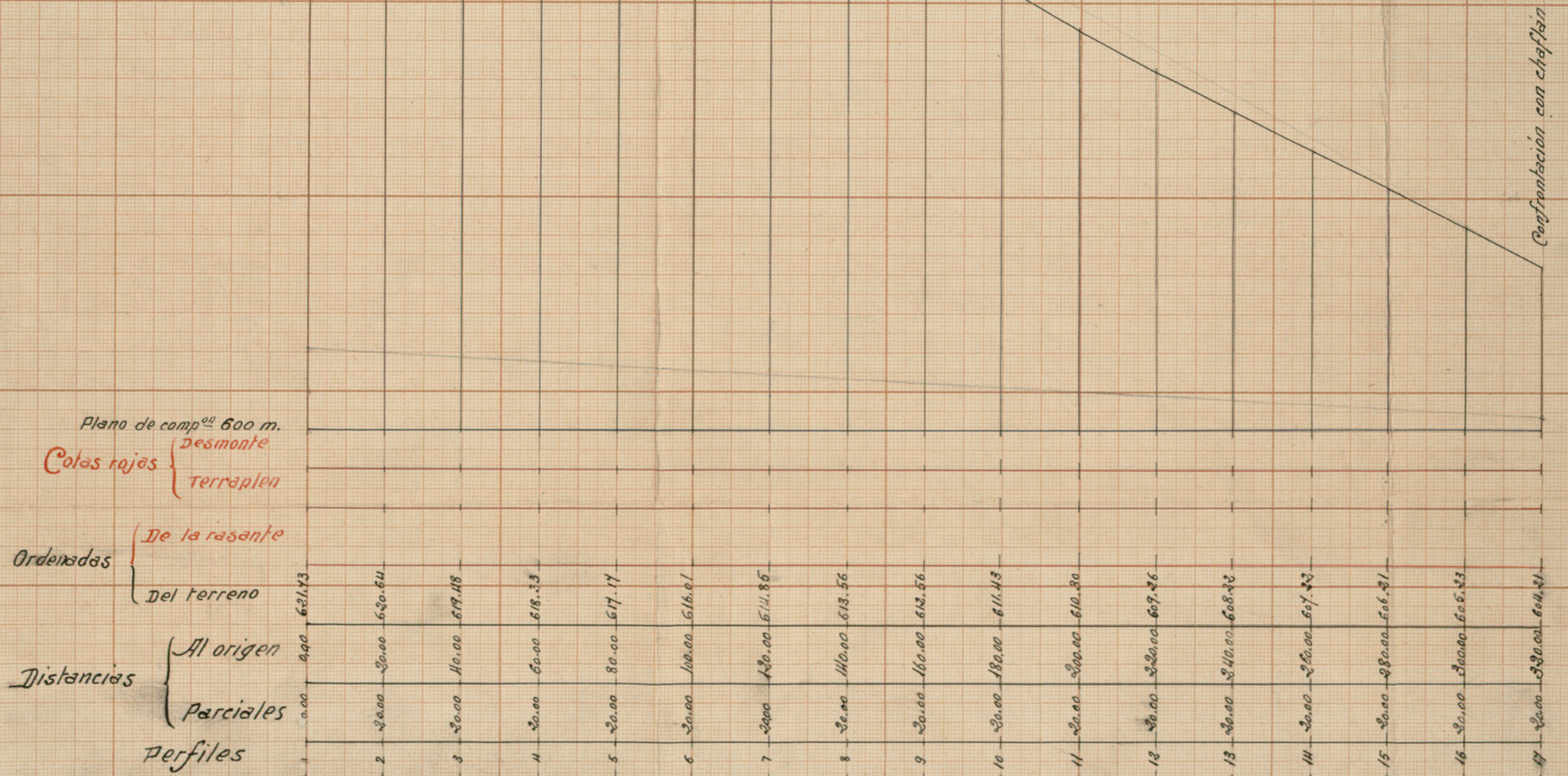

8 J

Perfil 9 J

Perfil 10 J

Perfil 11 J

Perfil 12 J

Perfil 13 J

Perfil 14 J

Perfil 15 J

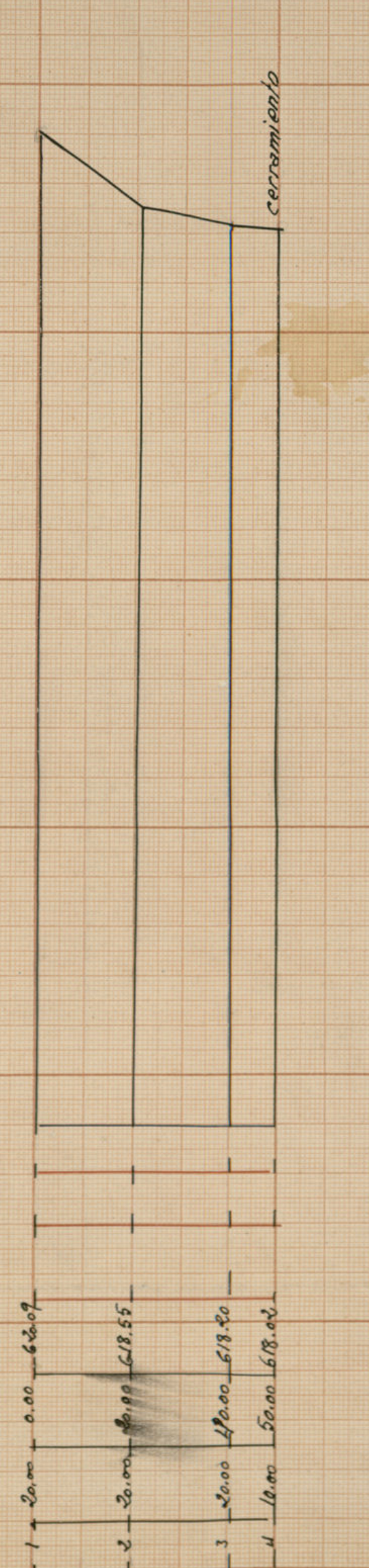
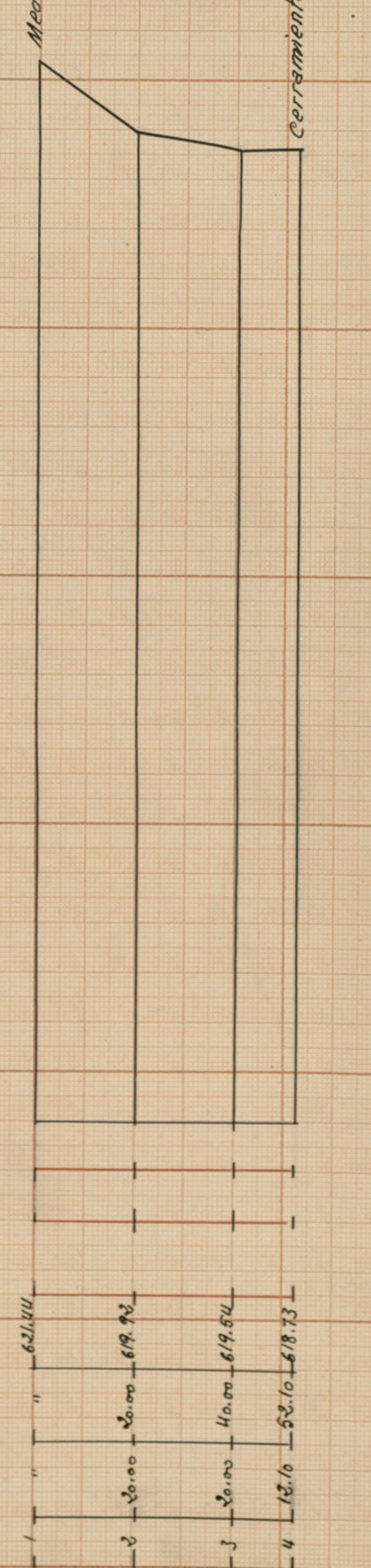
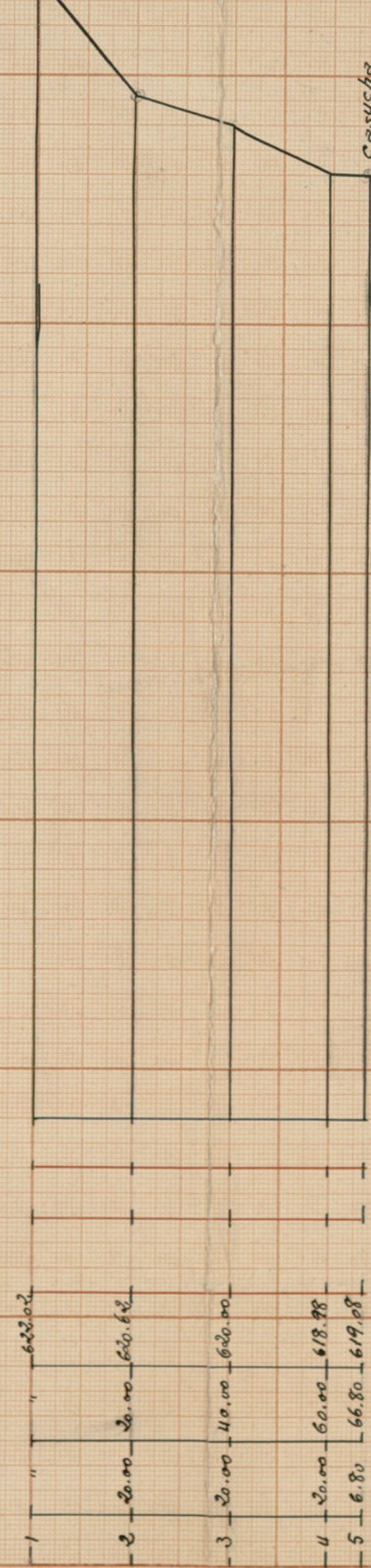
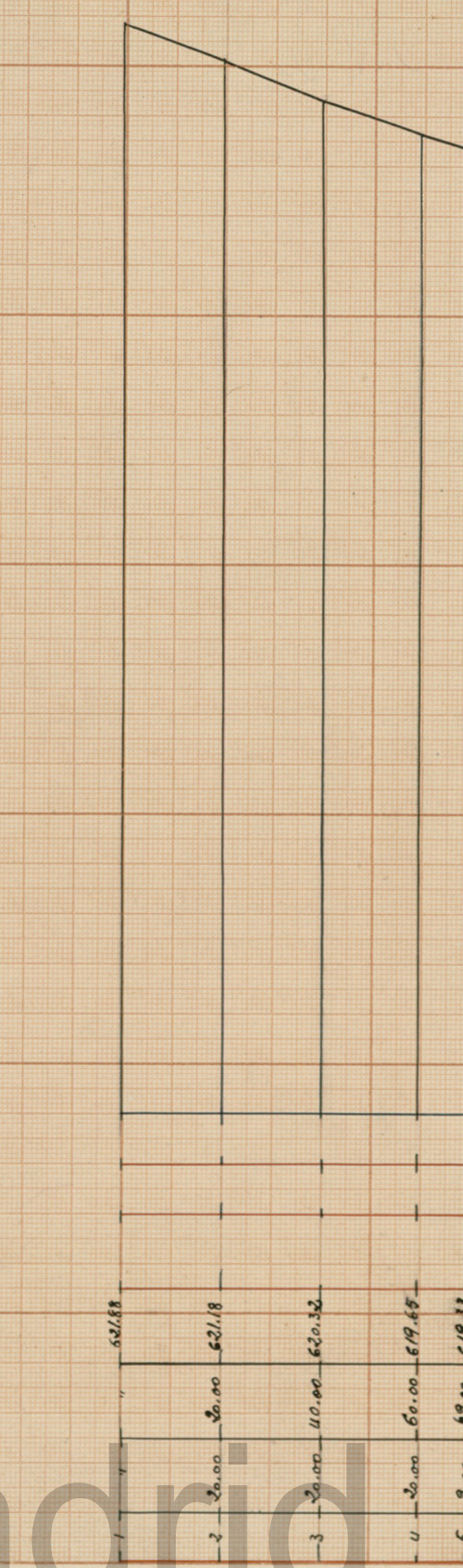
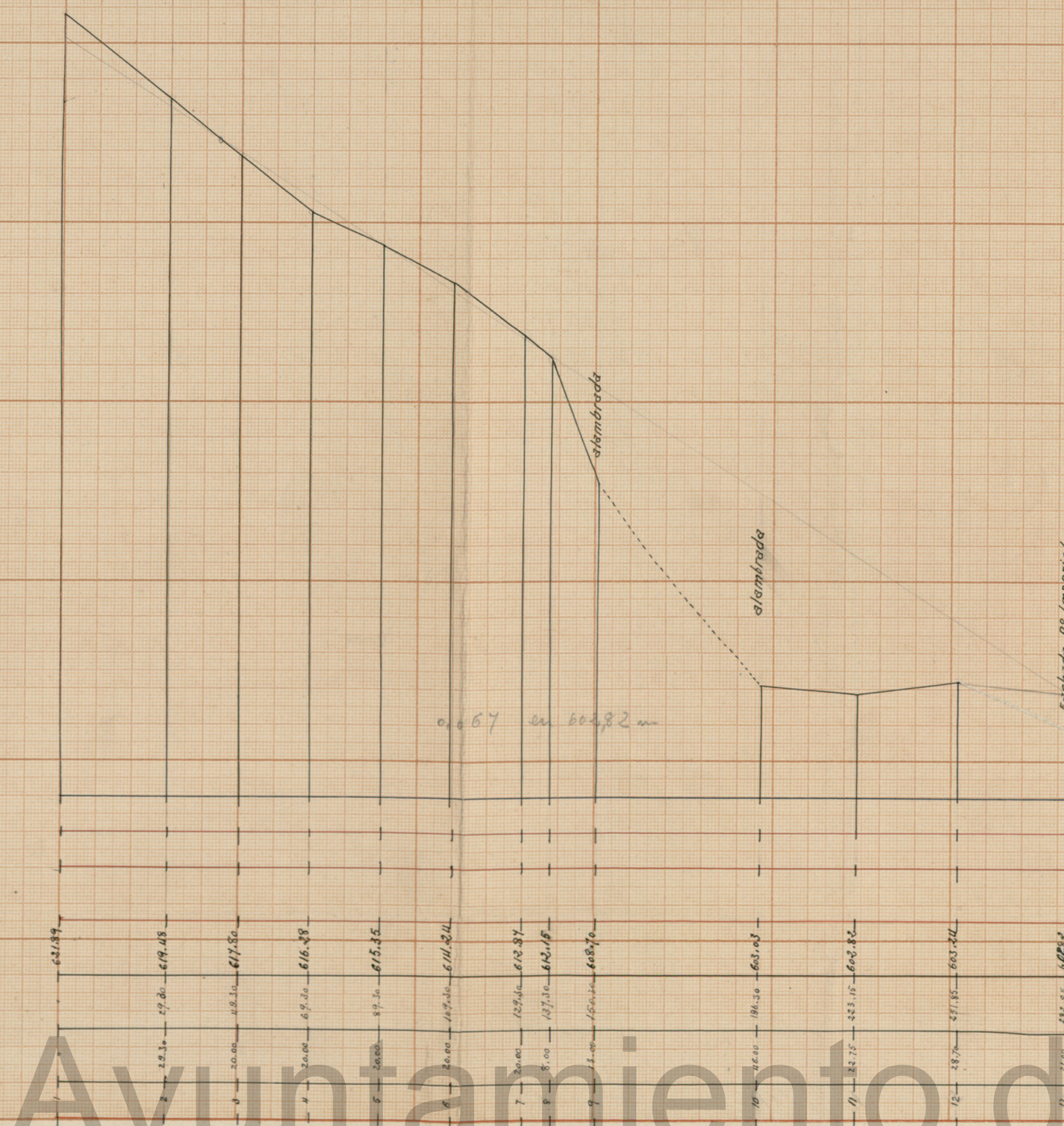
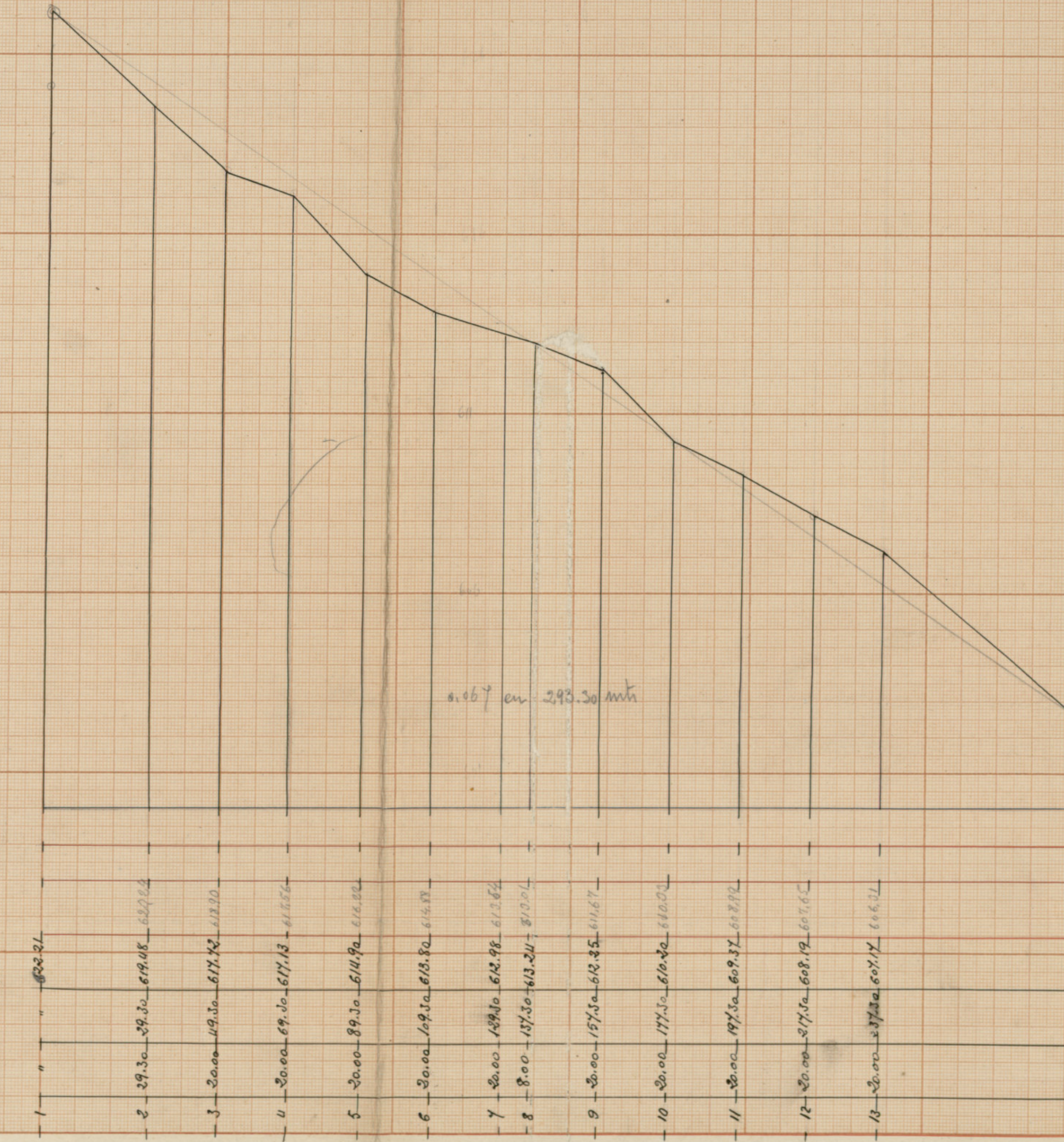
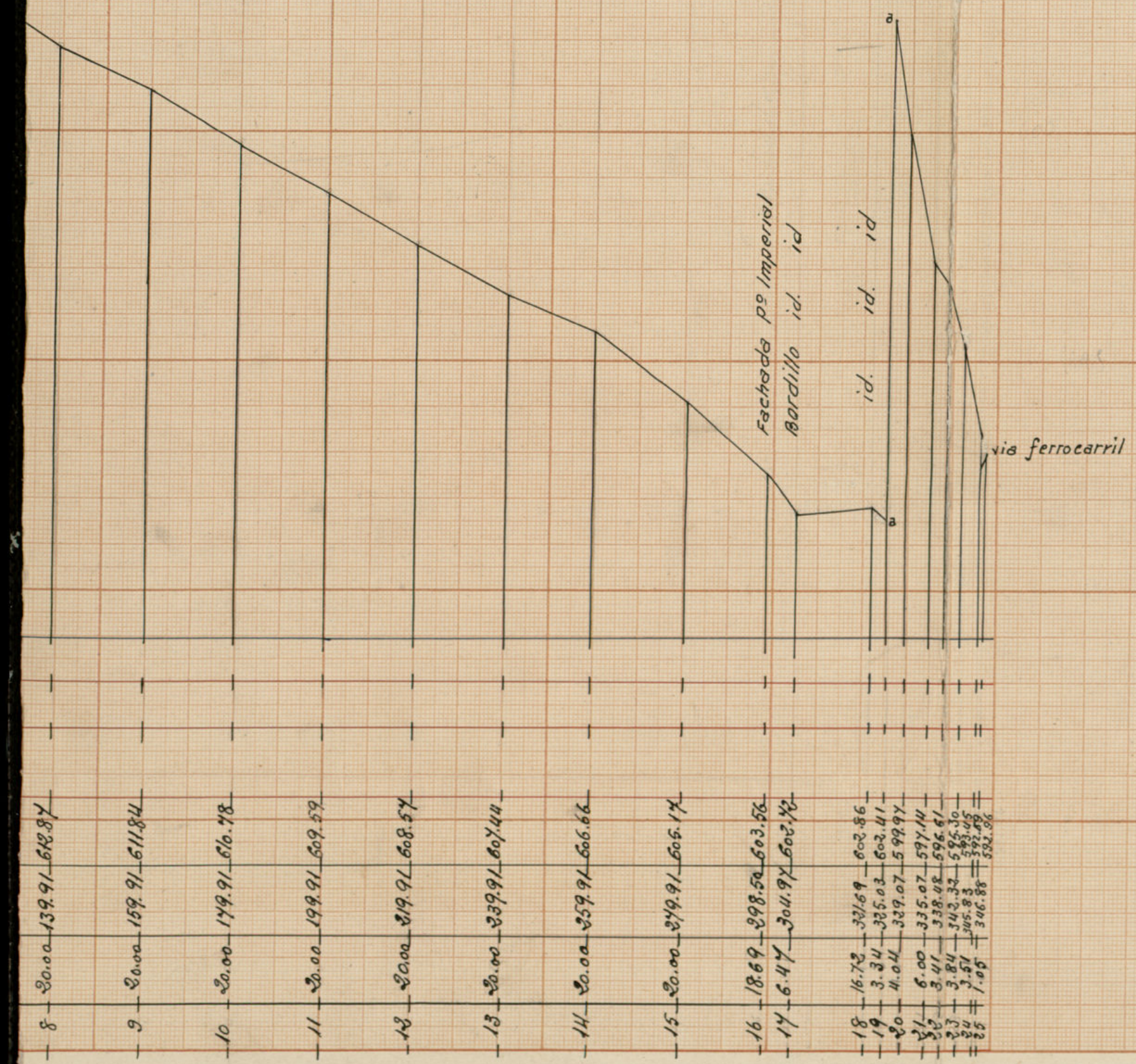

Ayuntamiento de Madrid

Mercado de ganado

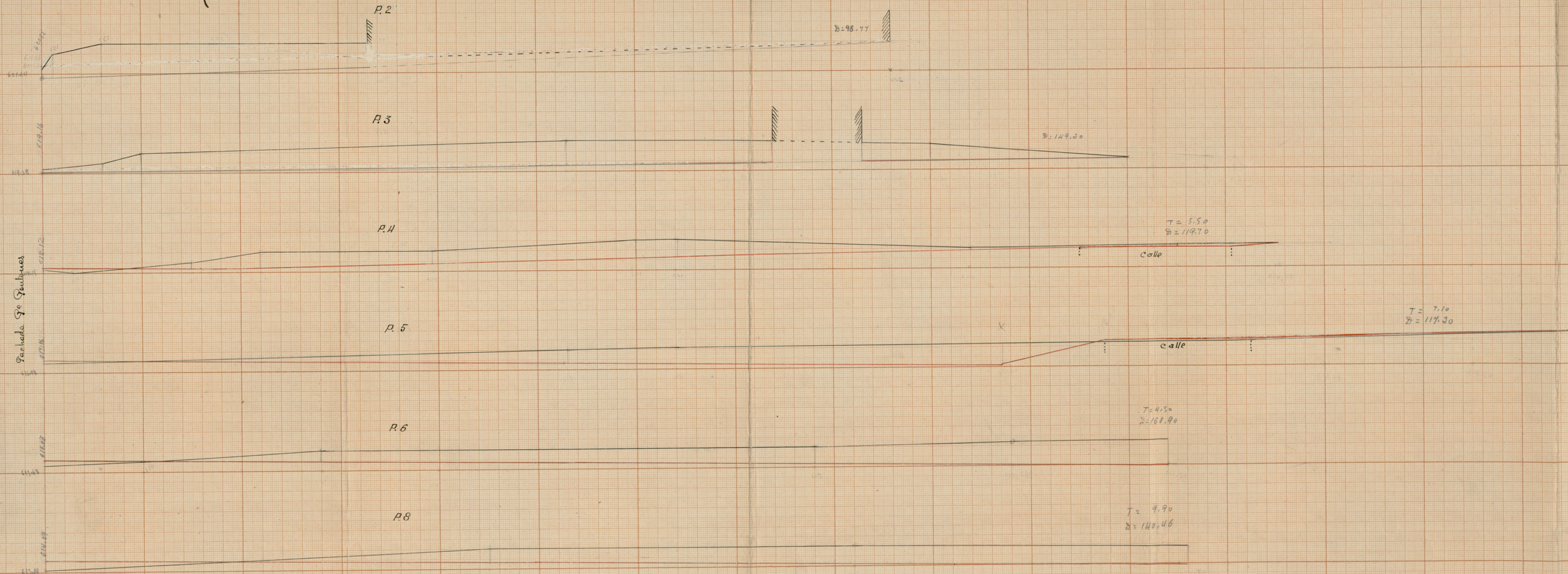

Escala 1:200

Ayuntamiento de Madrid

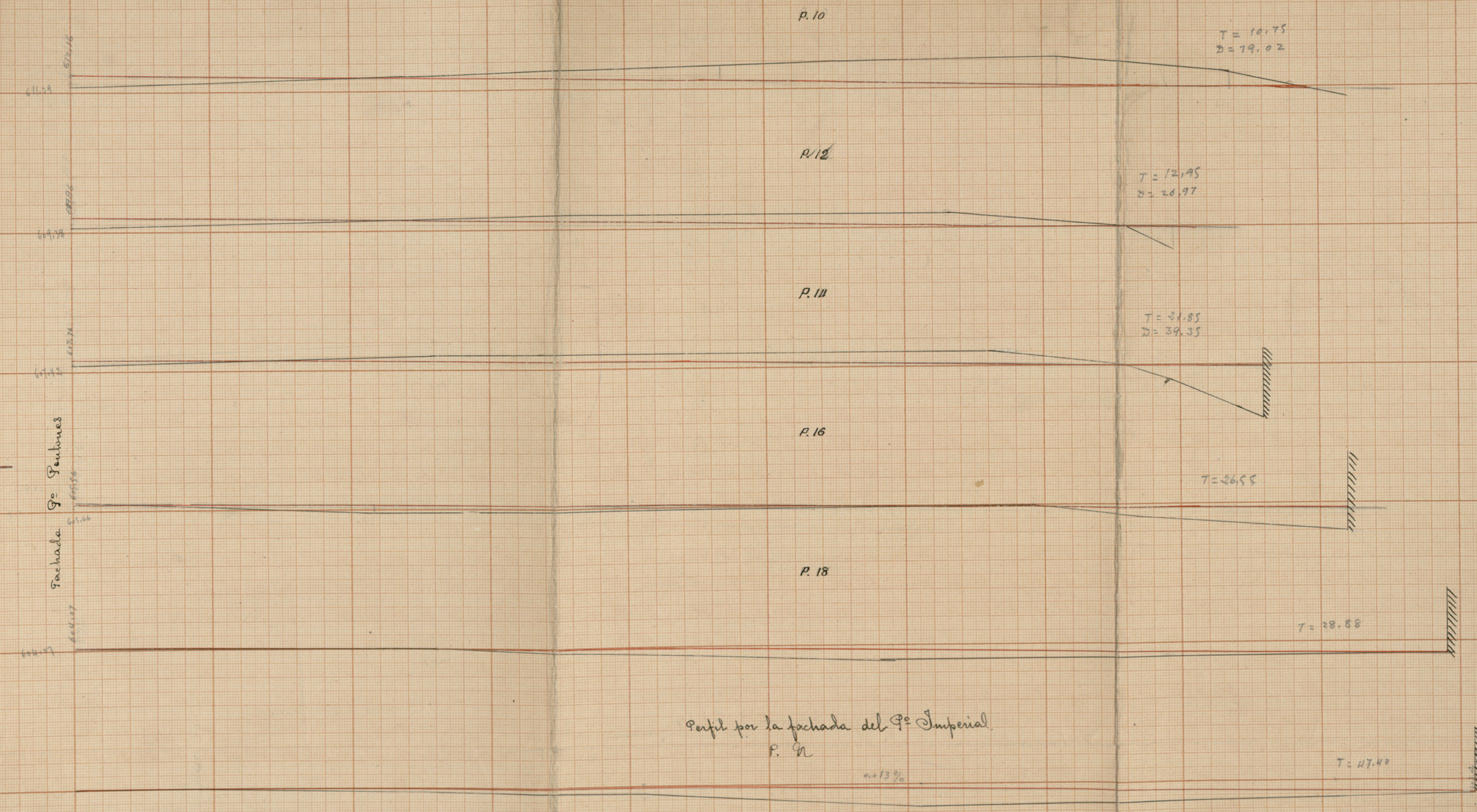

Perfil por la fachada del P. Imperial
P. 9

0.013%

T = 47.40

Perfil por la fachada del paseo de los Pontones.

Caseta

55

121

255.50

616

611

Pte. 0.0 65
en 55.00 mts.

X (Ata) en
12.00

P. 0.0 55 en 255.50 mts.

una el ceramieuto

chafan

1	"	622.22	421.38
2	20.00	20.00	621.64
3	20.00	40.00	619.38
3'	15.00	15.00	618.12
4	20.00	60.00	618.15
4'	7.00	67.00	618.12
5	17.50	84.50	616.98
6	20.00	104.50	615.68
7	18.00	122.50	614.59
8	17.80	140.30	613.19
9	15.00	155.30	612.70
10	20.00	175.30	611.39
11	20.00	195.30	610.52
12	20.00	215.30	609.96
13	20.00	235.30	608.88
14	20.00	255.30	607.42
15	20.00	275.30	606.66
16	20.00	295.30	605.66
17	20.00	315.30	604.80
18	4.20	323.50	604.07